



**Lake Road Station**  
Milwaukie – 1950s

**Kellogg Bridge Structure**





**Kellogg Bridge**

Aerial



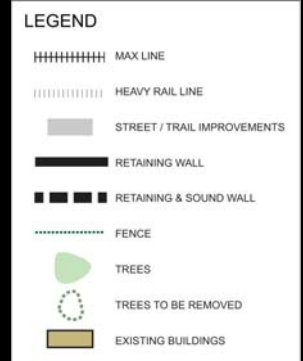

**Kellogg Bridge**  
 Site Plan

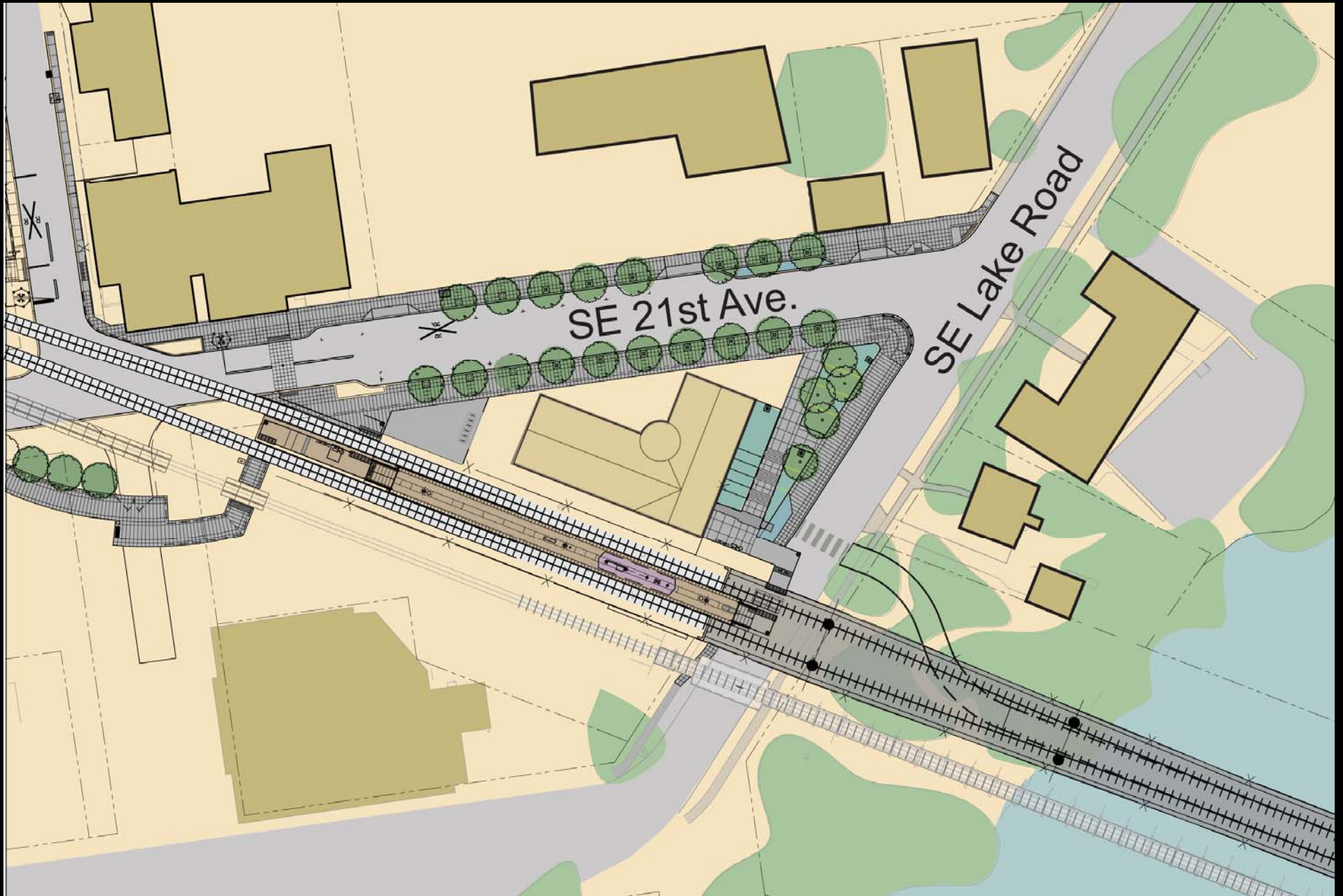

## Kellogg Bridge

Lake Road Plan

# Objectives and Opportunities

- Create a simple, elegant connector between Milwaukie and Oak Grove
- Bring a sense of craft to standard bridge elements within structural, functional, safety/security, and cost considerations
- Enhance the sense of arrival to Milwaukie
- Consider the experience of the bridge from the vantage point of drivers, light rail riders, pedestrians, and bicyclists

# Design Goals

- Create a graceful “ribbon” in the landscape that bridges the varied environments below
- Use a consistent material to achieve a ribbon effect
- Maintain a consistent depth and profile for the spanning elements to achieve a ribbon effect
- Provide textural and/or sculptural effects in the pedestrian zone to create visual interest and a sense of craft

## **Kellogg Bridge**

Objectives & Opportunities

Design Goals





**Kellogg Bridge**  
Preliminary Engineering



**Kellogg Bridge**

March 17





**Kellogg Bridge**

Steel Tub



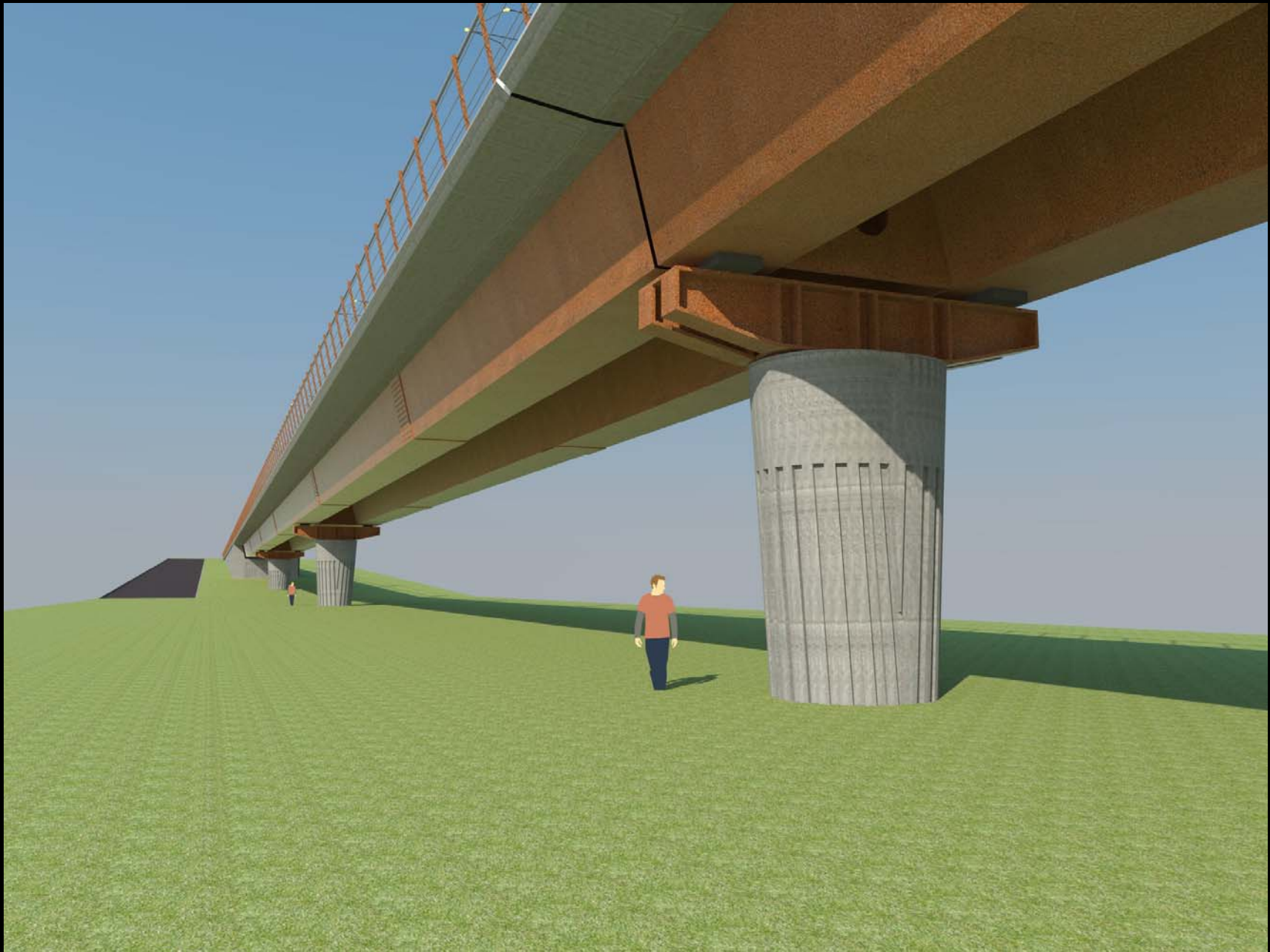

**Kellogg Bridge**

Tapered Column



**Kellogg Bridge**

Metal Cladding





**Kellogg Bridge**  
Current Scheme



## **Kellogg Bridge**

Current Scheme





**Kellogg Bridge**  
Board-formed Finish



## **Kellogg Bridge**

SE McLoughlin Boulevard





**Kellogg Bridge**  
SE River Road



**Kellogg Bridge**

SE 22<sup>nd</sup> Avenue





**Kellogg Bridge**

SE McLoughlin Boulevard



**Kellogg Bridge**  
South Abutment





**Kellogg Bridge**

Kronberg Park



**Kellogg Bridge**

Kronberg Park





## **Kellogg Bridge**

Kronberg Park



**Kellogg Bridge**  
Pedestrian Bridge



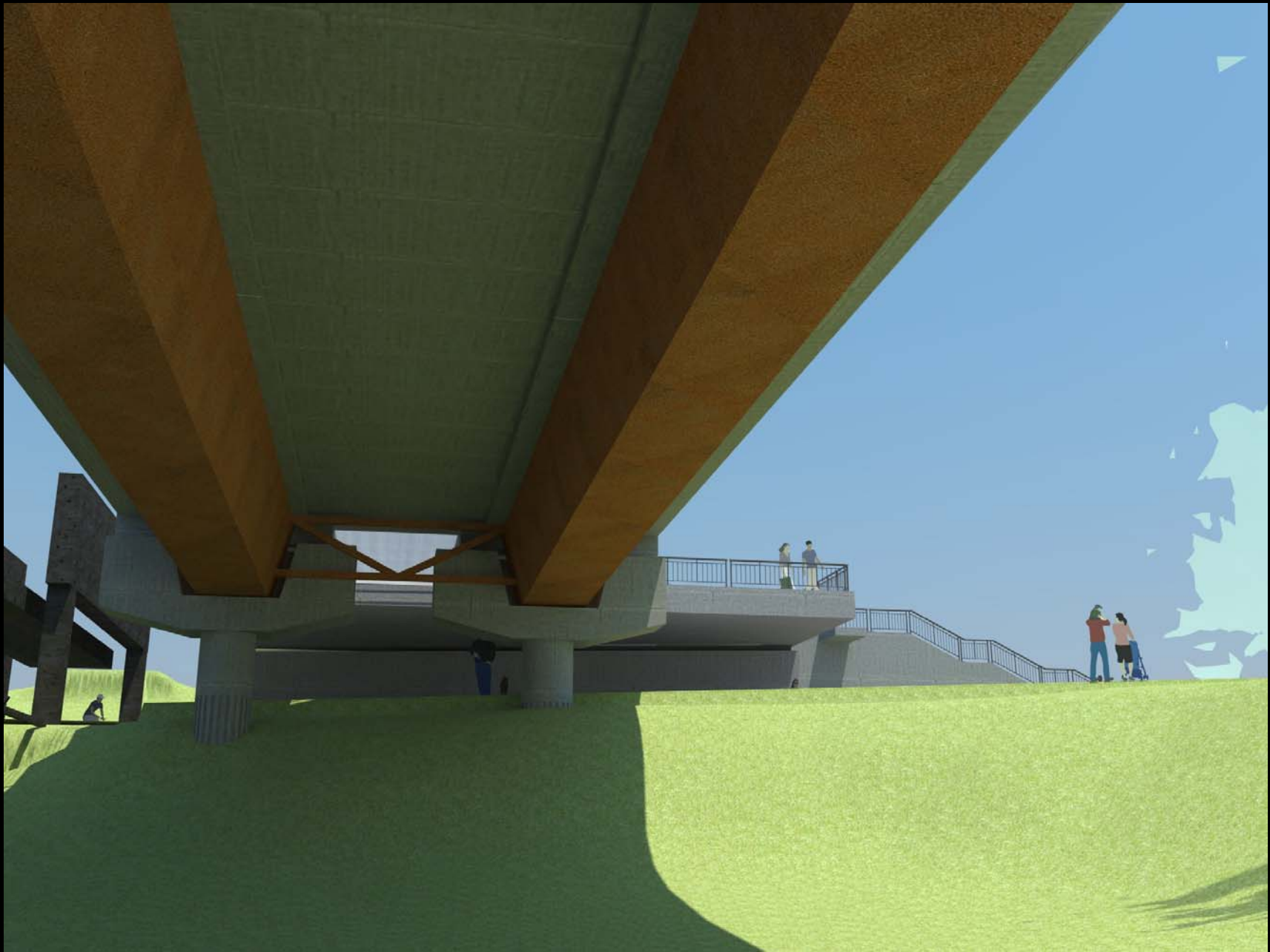

**Kellogg Bridge**

Lake Road



**Kellogg Bridge**

Lake Road



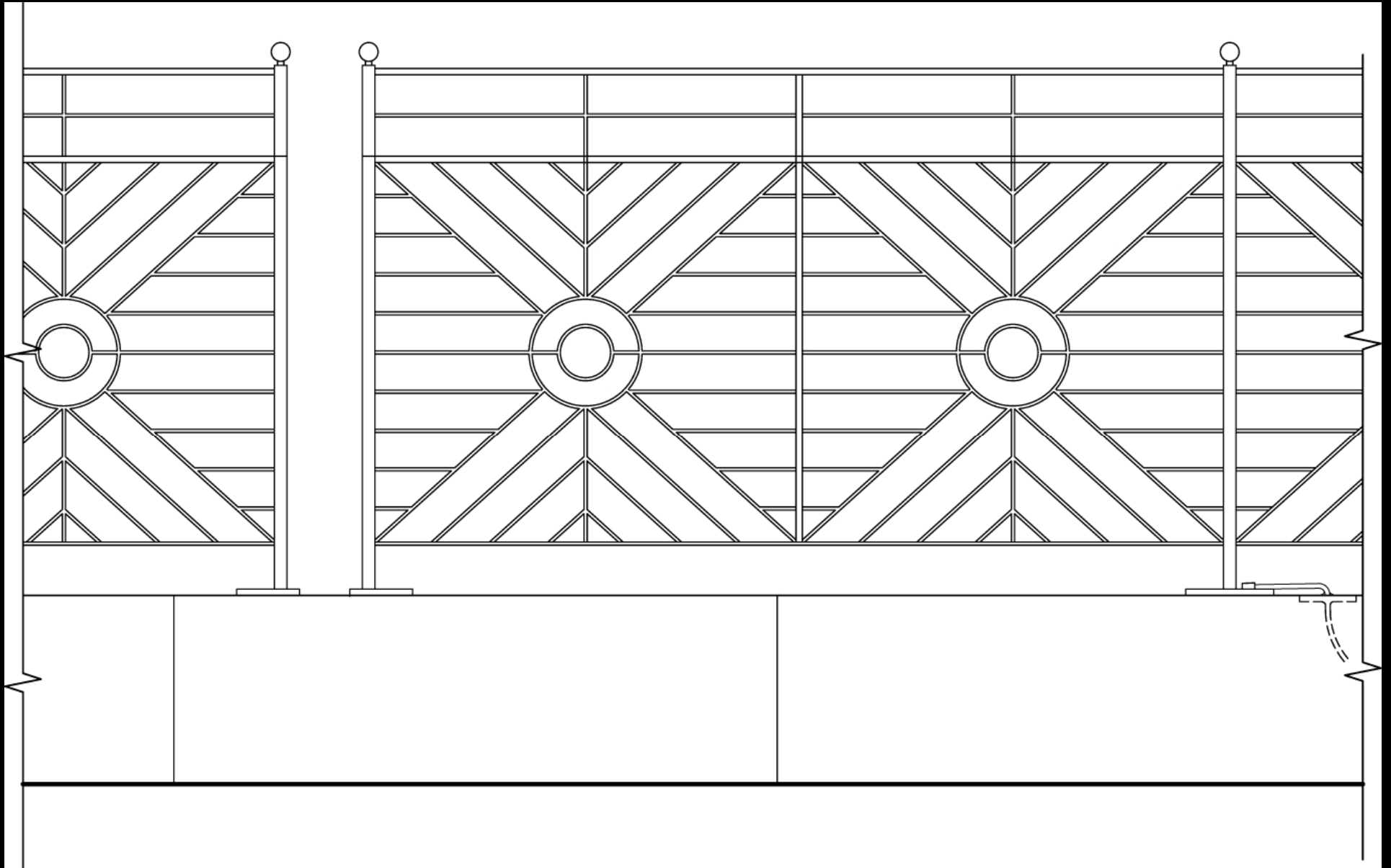

**Kellogg Bridge**  
Guardrail

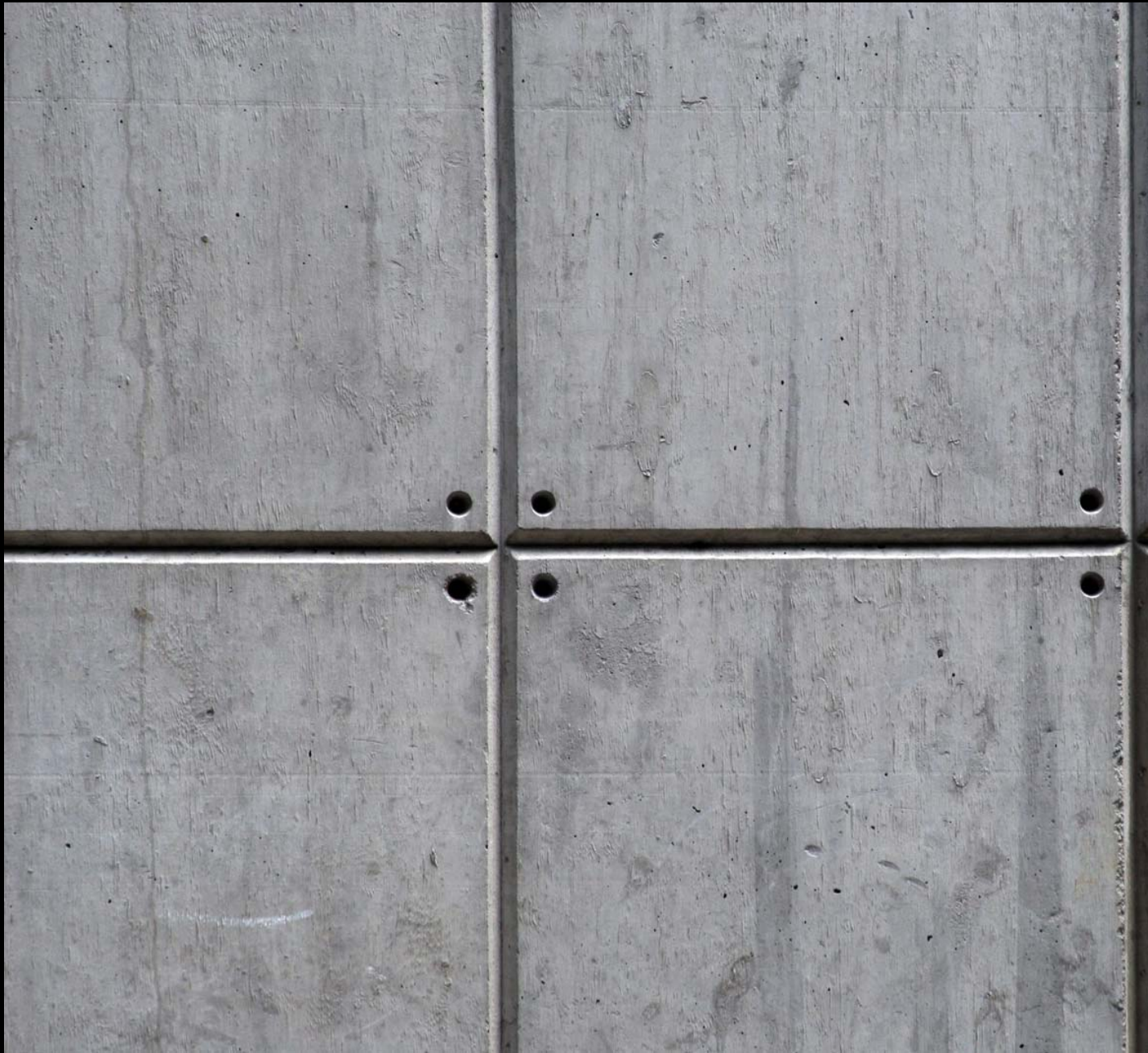

**Kellogg Bridge**  
Concrete Wall





**Kellogg Bridge**

Lake Road

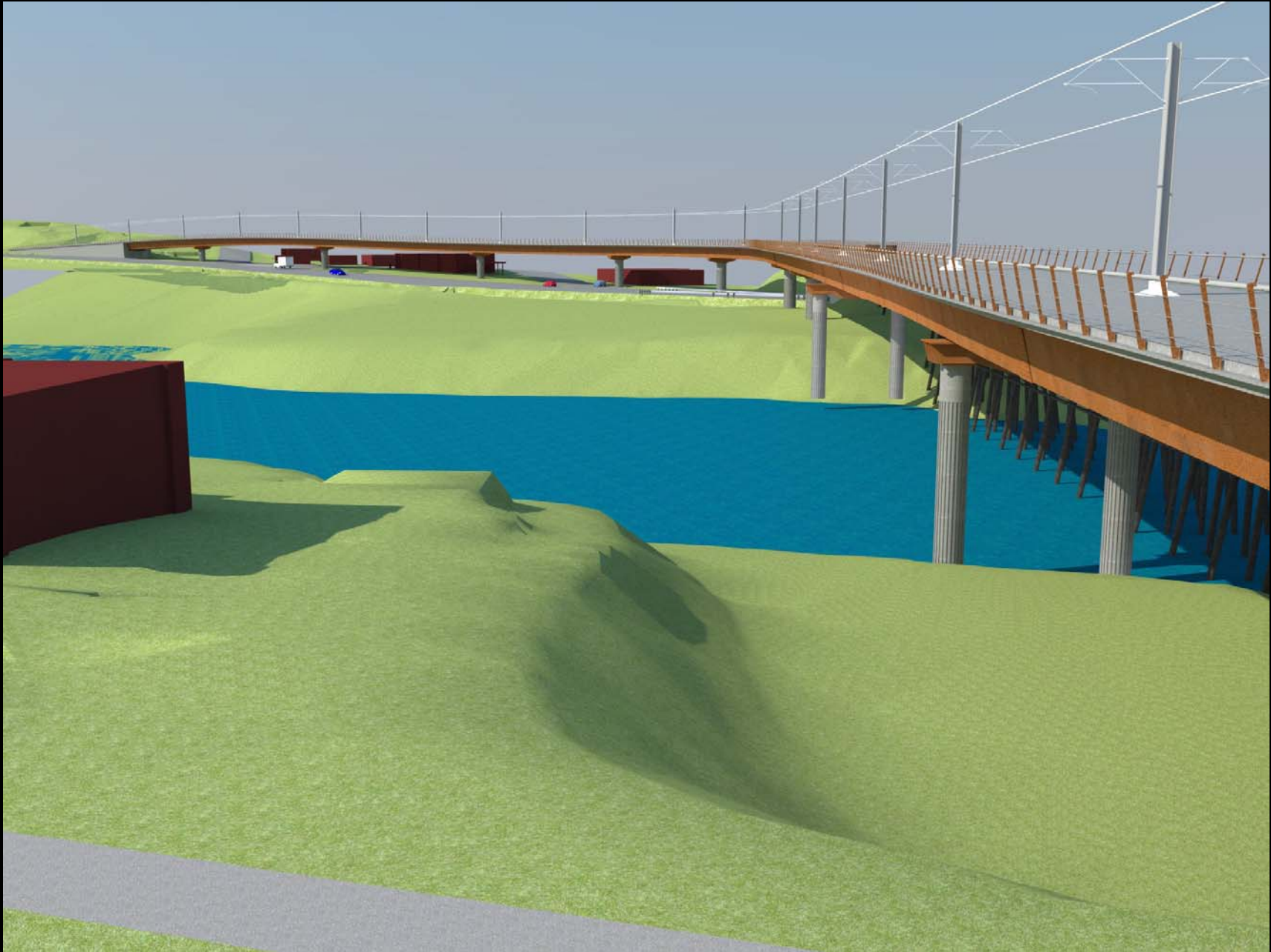

**Kellogg Bridge**

Kellogg Lake



**End**