

Milwaukie Station

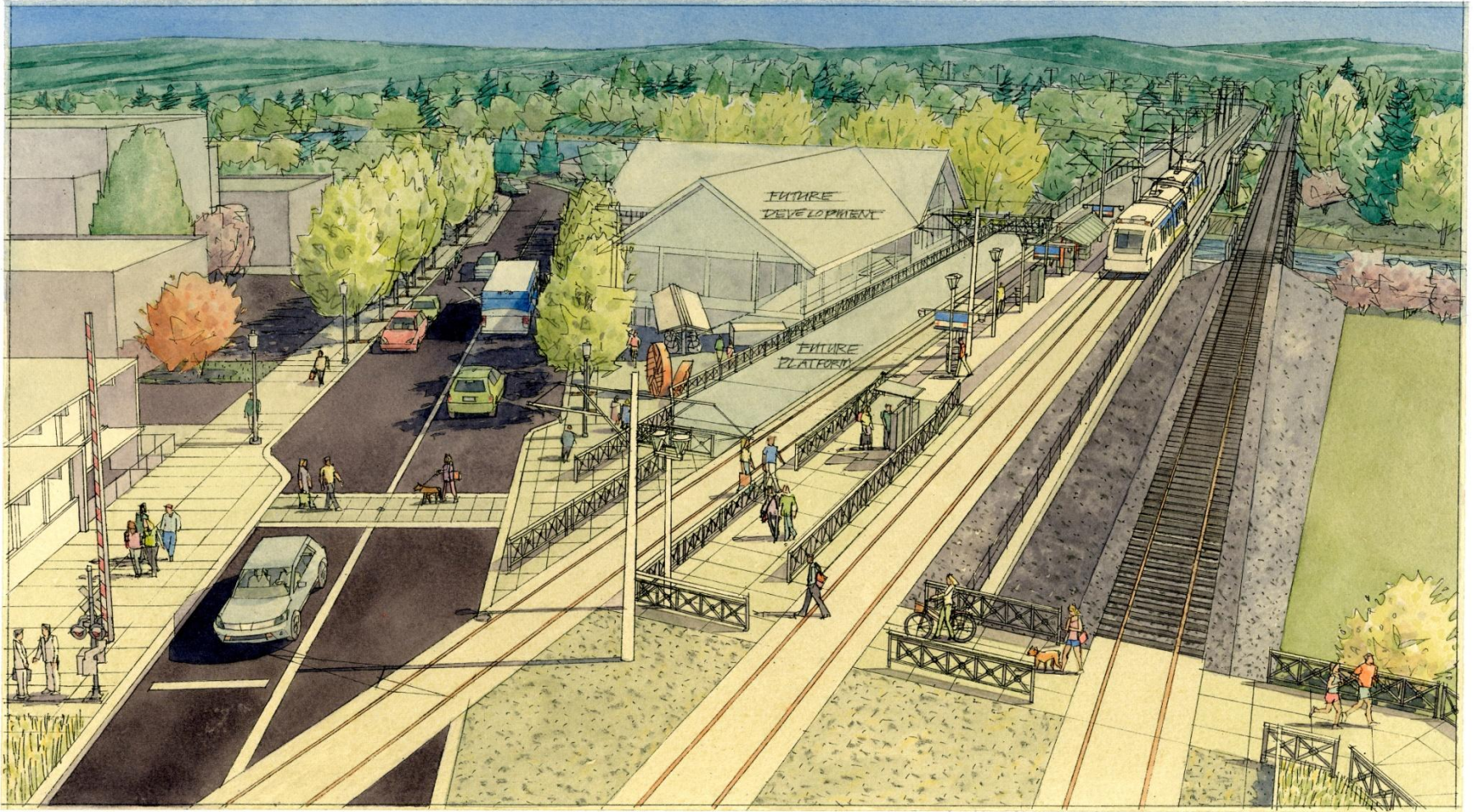

January 30, 2012

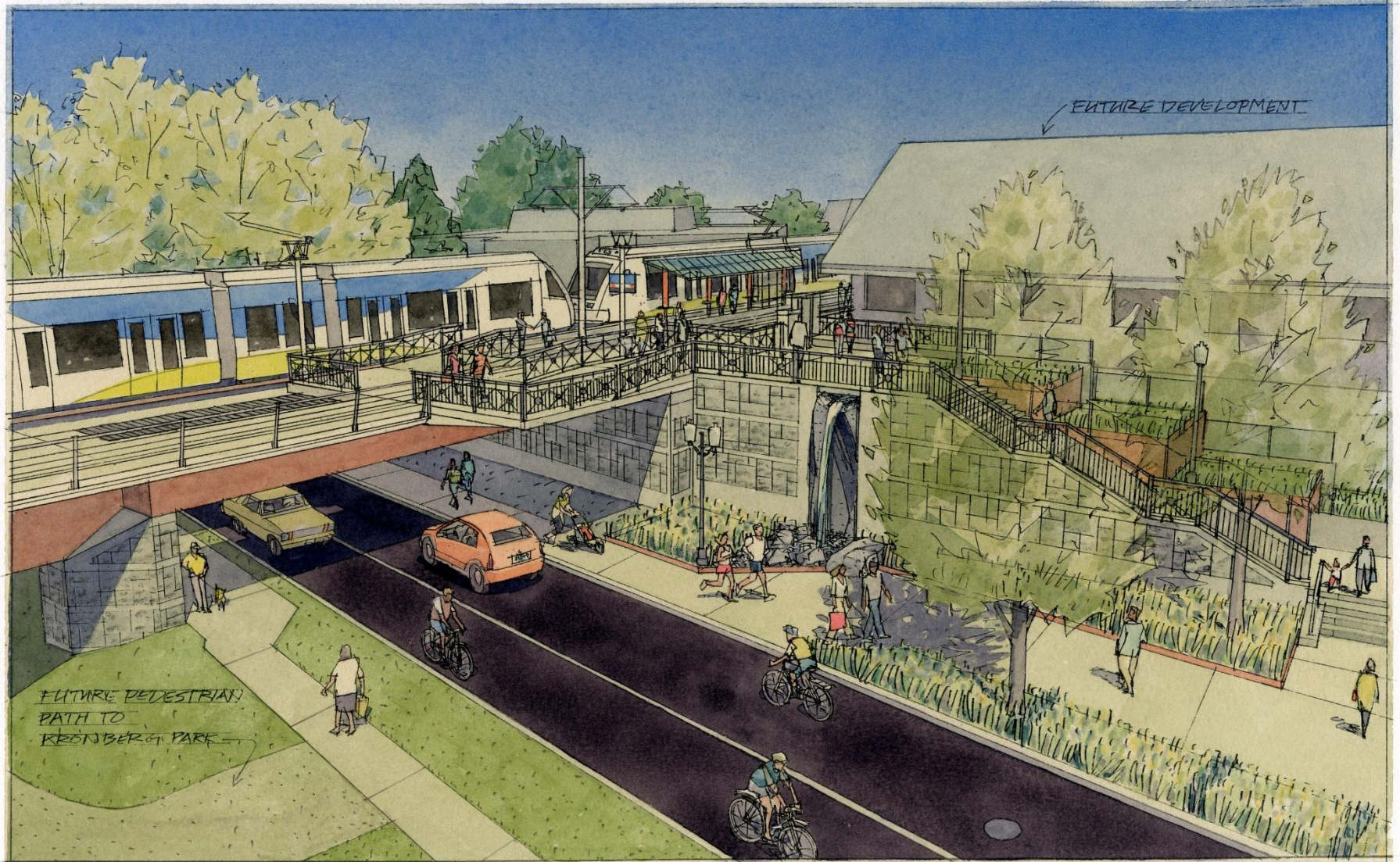



Milwaukie Station

January 30, 2012

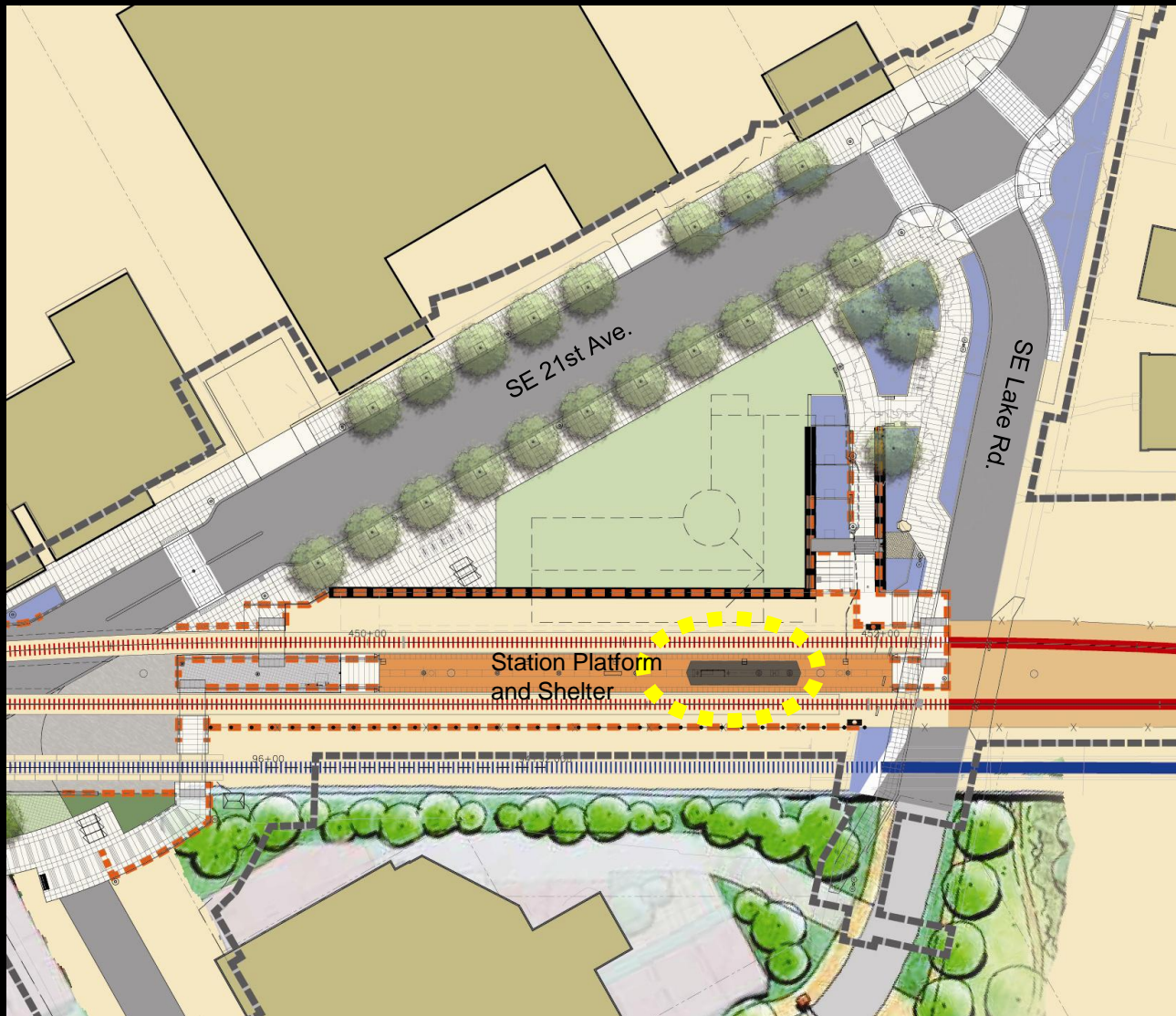

Milwaukie Station

Station Shelter

January 30, 2012

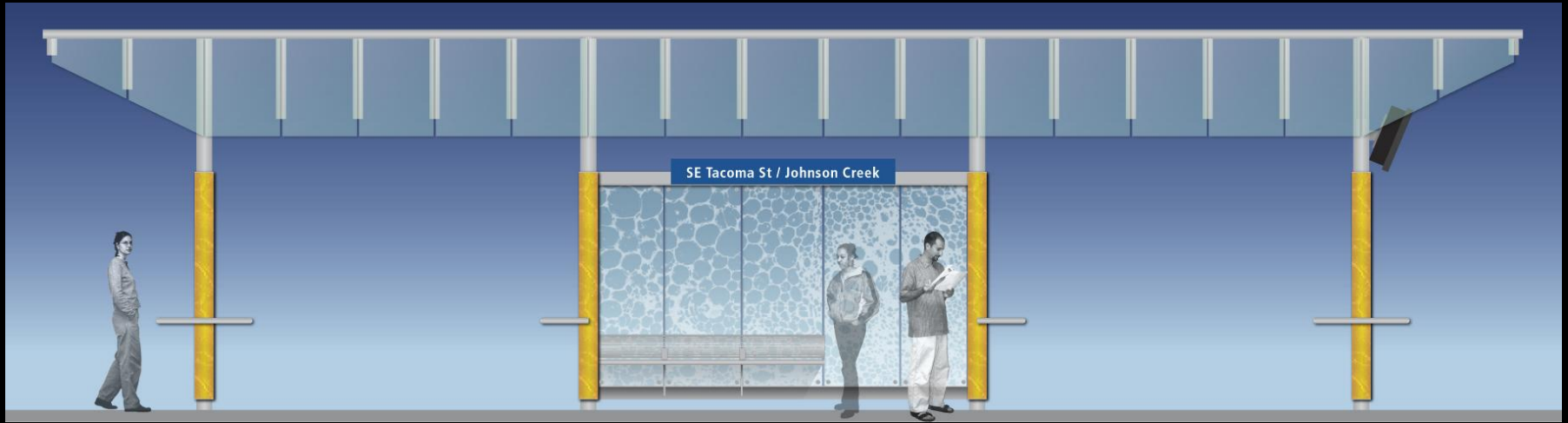

Milwaukie Station

Standard Platform Shelter

January 30, 2012



Milwaukie Station

Standard Platform Shelter

January 30, 2012



Milwaukie Station

Standard Platform Shelter

January 30, 2012



Milwaukie Station

Standard Platform Shelter

January 30, 2012



Milwaukie Station

Standard Platform Shelter

January 30, 2012



Milwaukie Station

Standard Platform Shelter

January 30, 2012



Milwaukie Station

Standard Platform Shelter

January 30, 2012

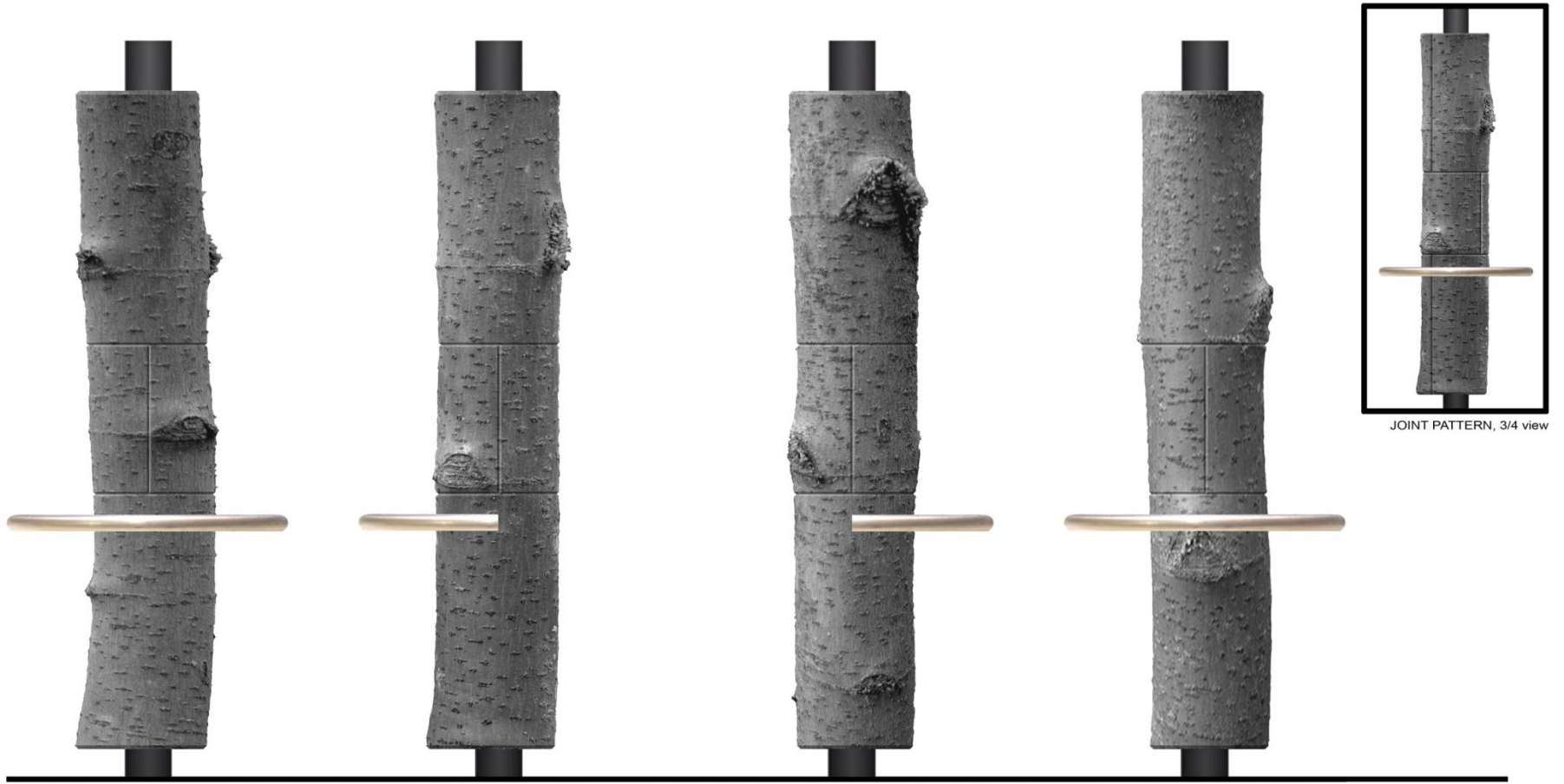

Milwaukie Station

Platform Shelter

January 30, 2012



Glass Roof / Black



Metal Roof / Black

Milwaukie Station

Platform Shelter

January 30, 2012

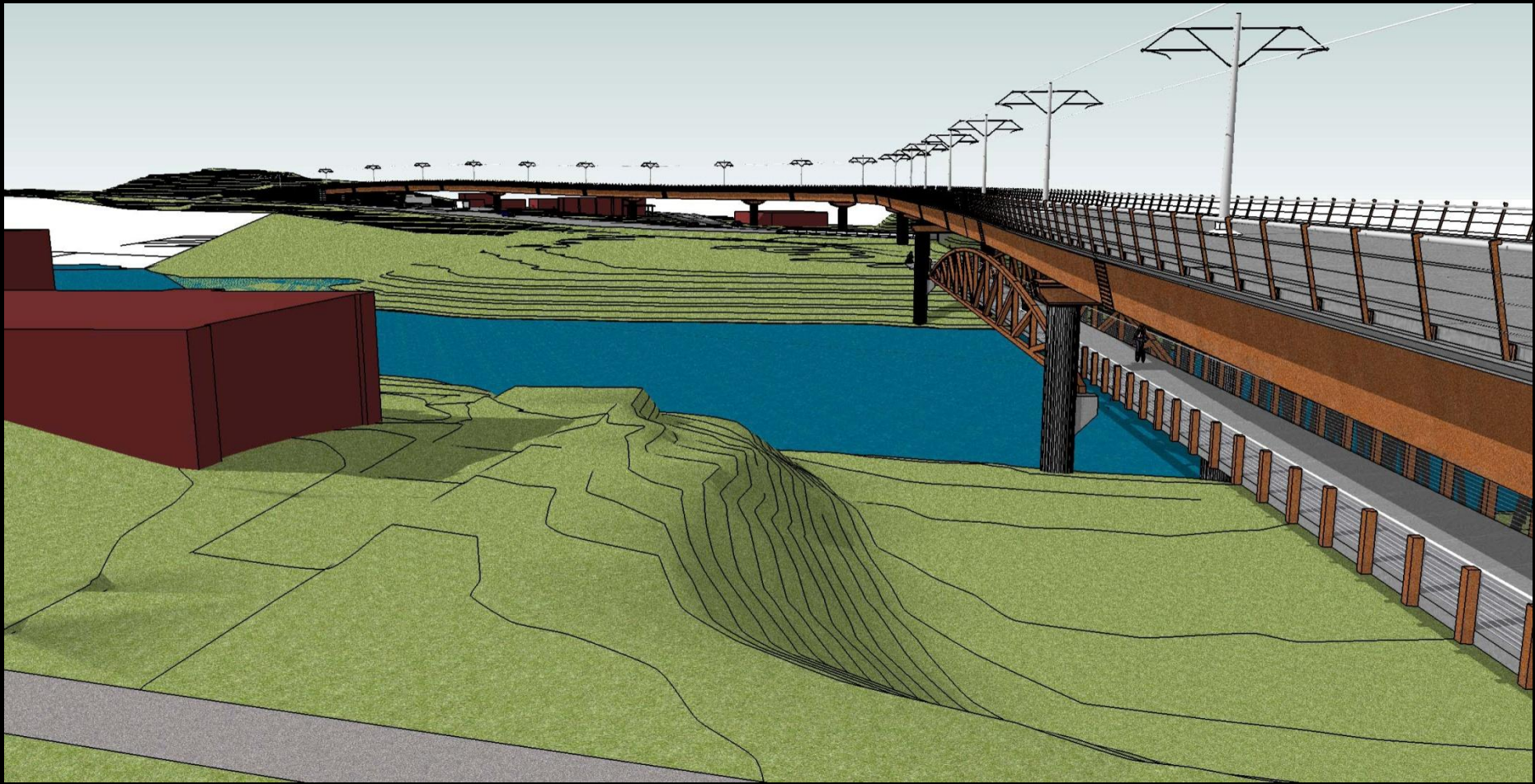

Kellogg Bridge

January 30, 2012

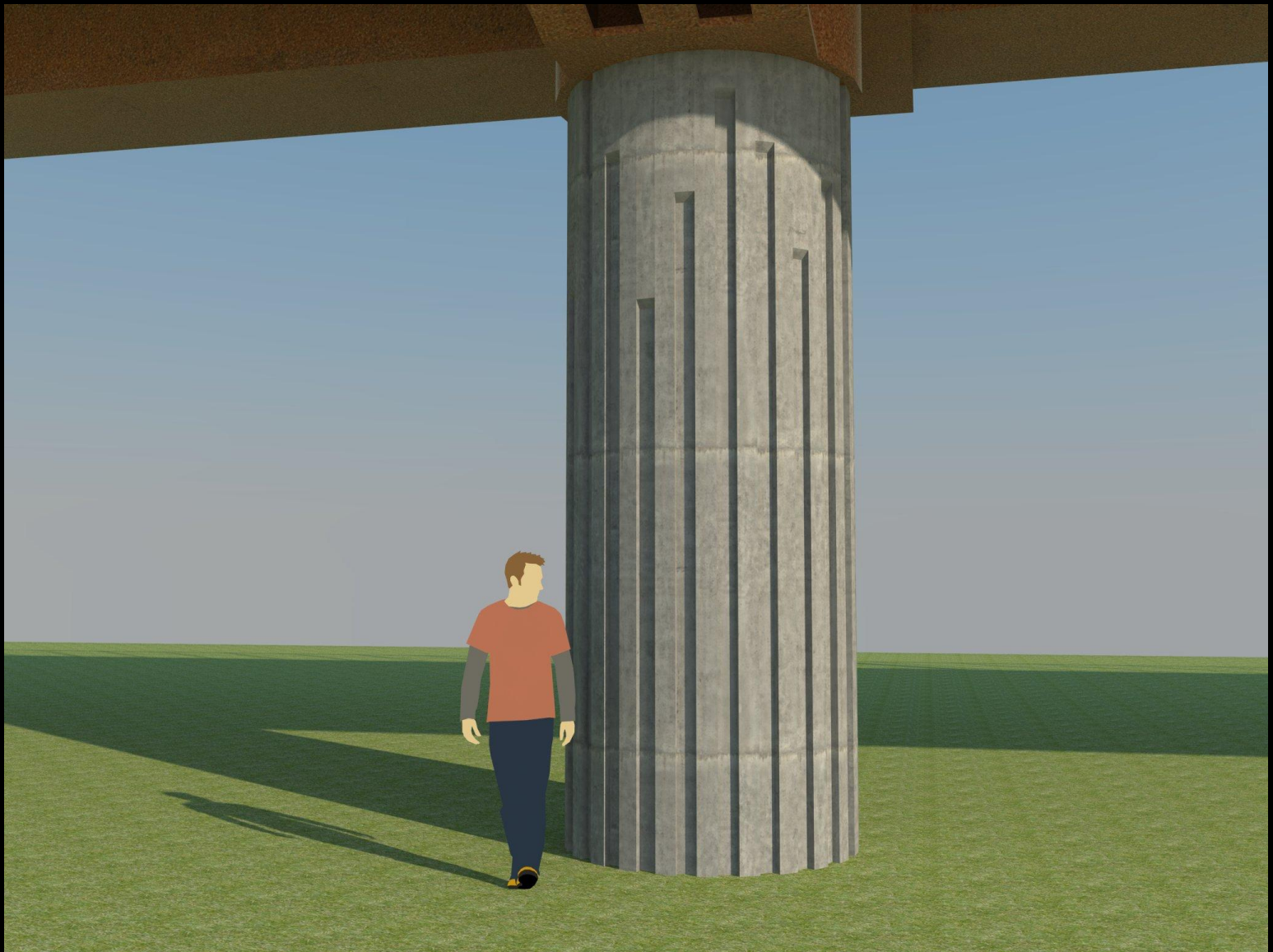

Kellogg Bridge

Bridge Column

January 30, 2012

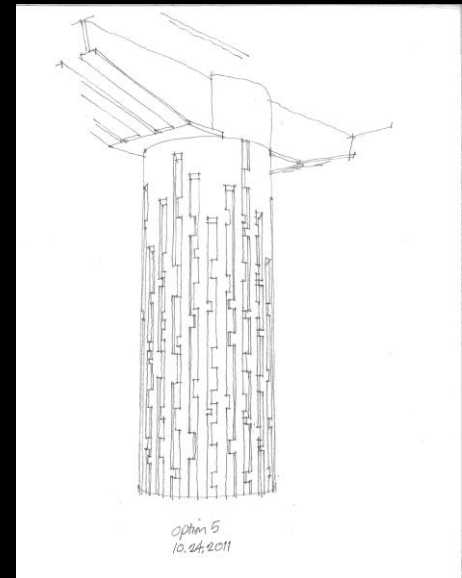
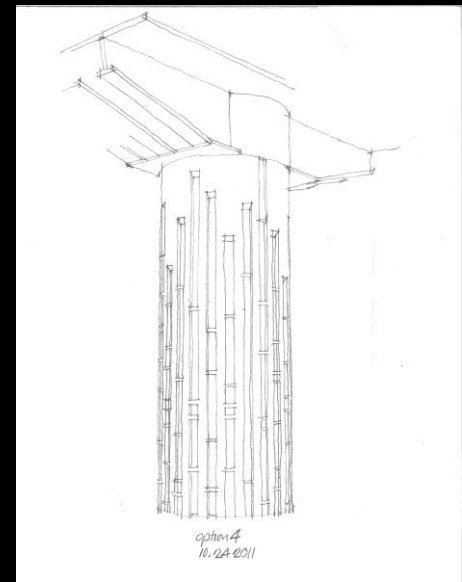
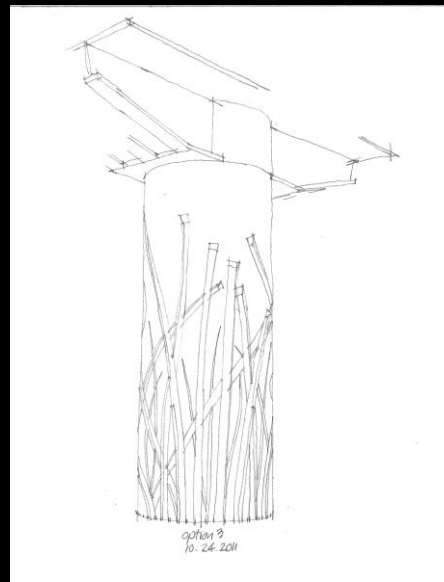
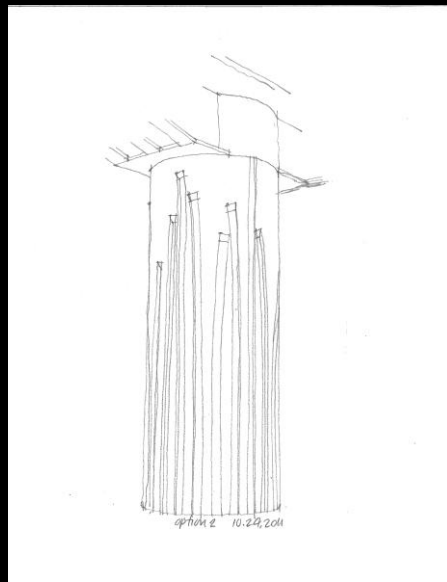
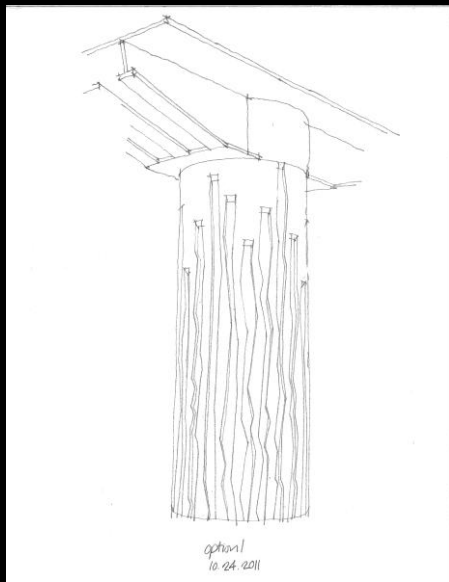

Kellogg Bridge
Bridge Column
January 30, 2012

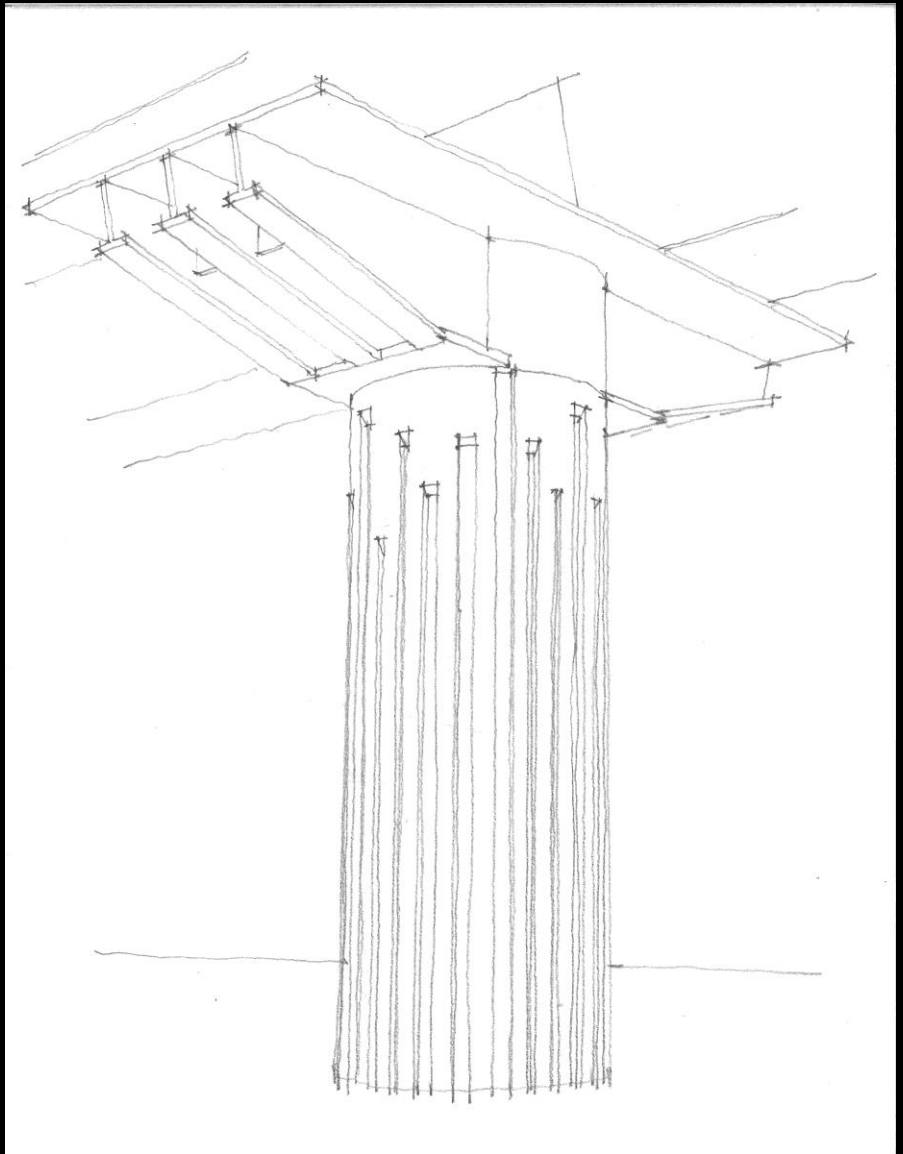

Kellogg Bridge

Bridge Column

January 30, 2012



Kellogg Bridge

Bridge Column

January 30, 2012



Kellogg Bridge

Bridge Column

January 30, 2012

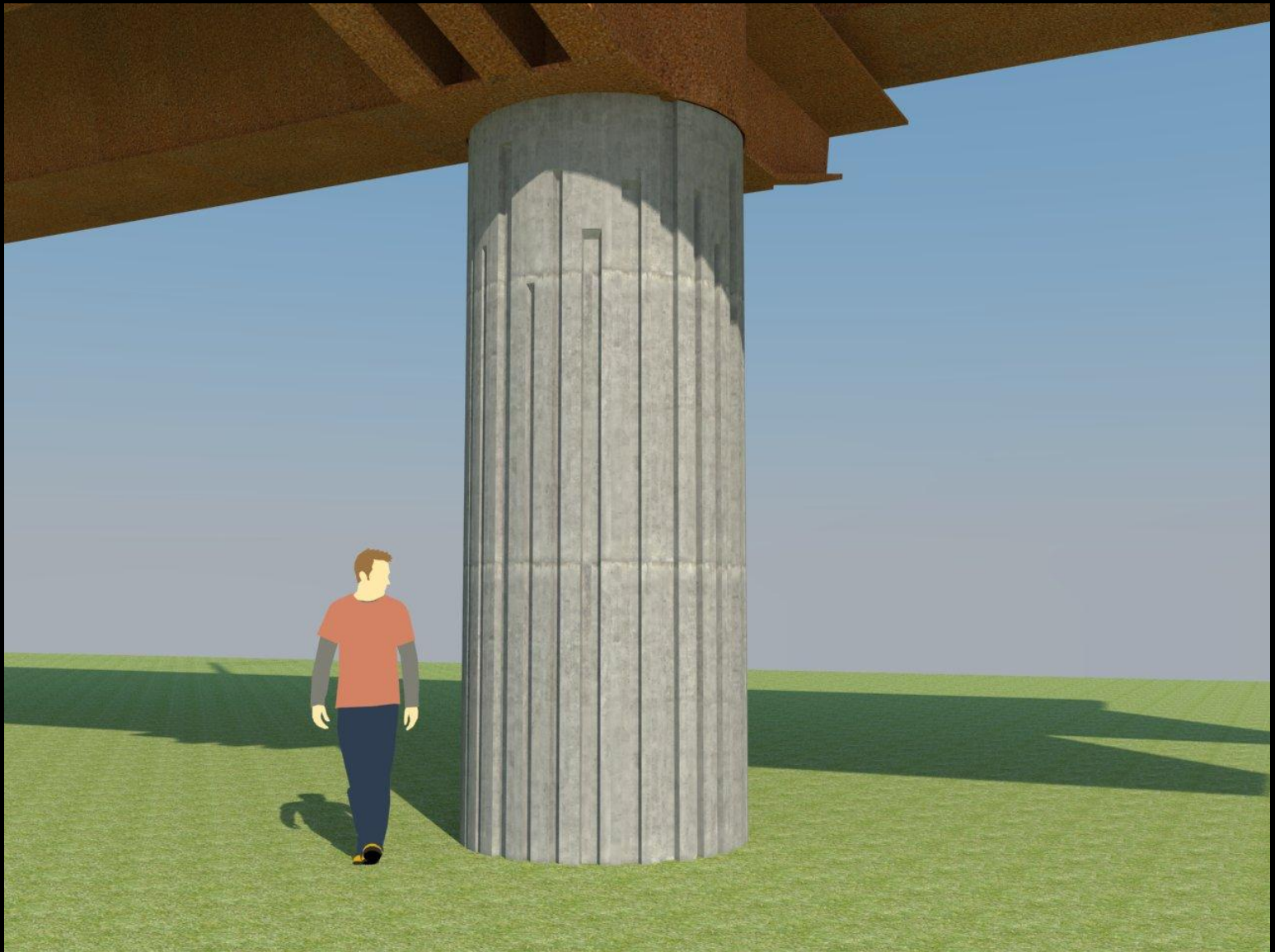

Kellogg Bridge

Bridge Column

January 30, 2012

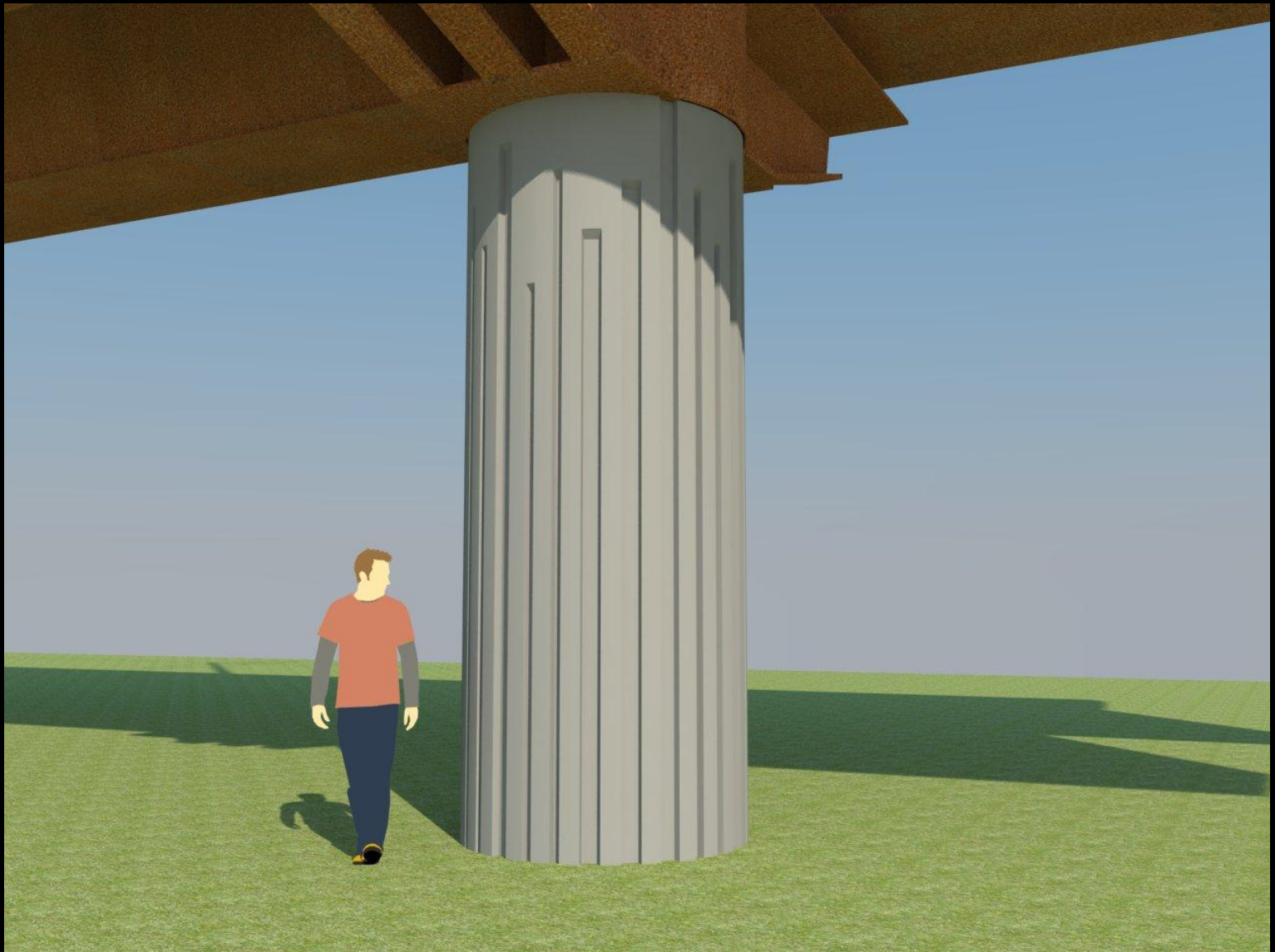

Kellogg Bridge

Bridge Column

January 30, 2012

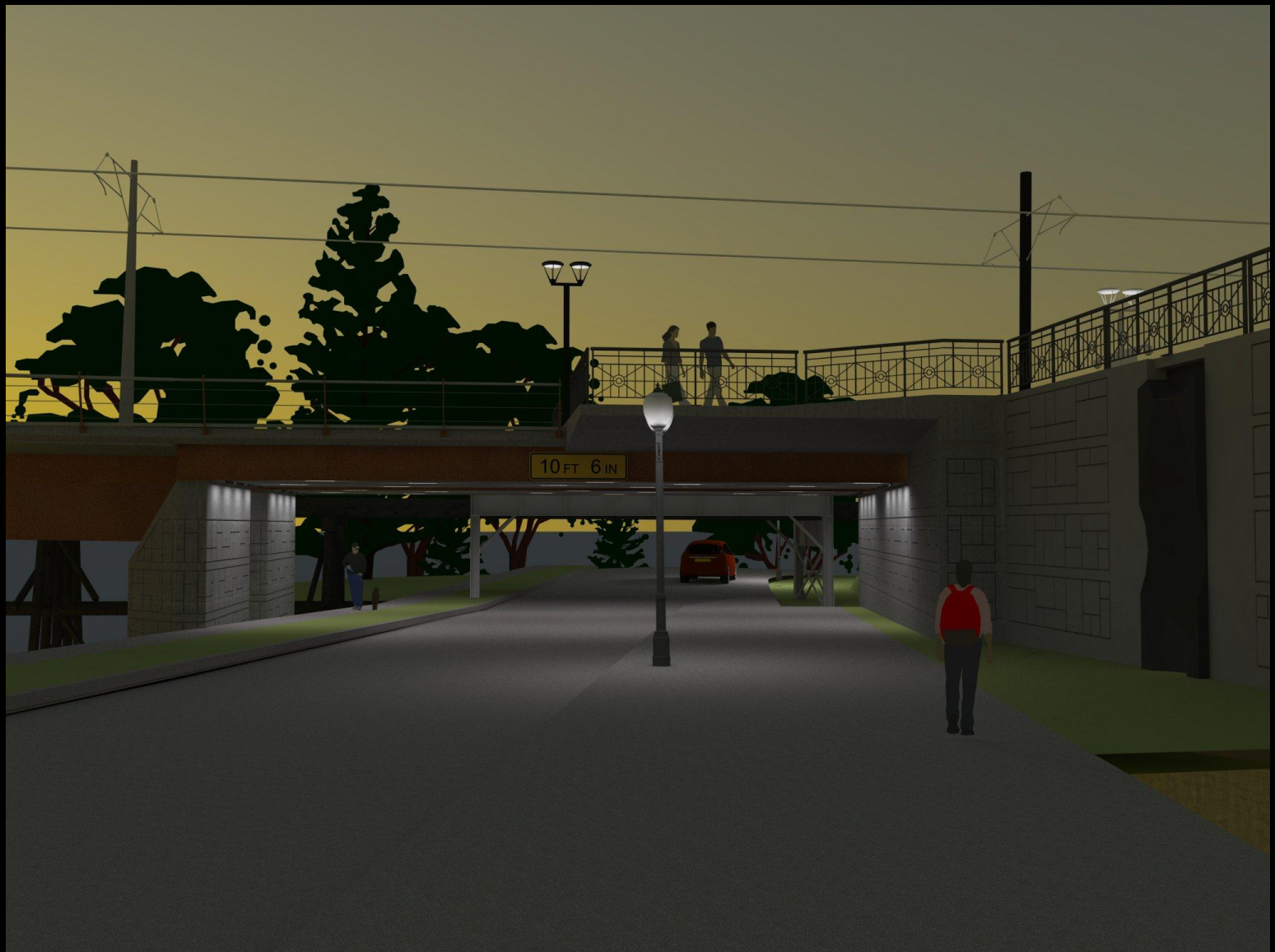

Kellogg Bridge

Jump Span Lighting

January 30, 2012



Kellogg Bridge

Jump Span Lighting

January 30, 2012

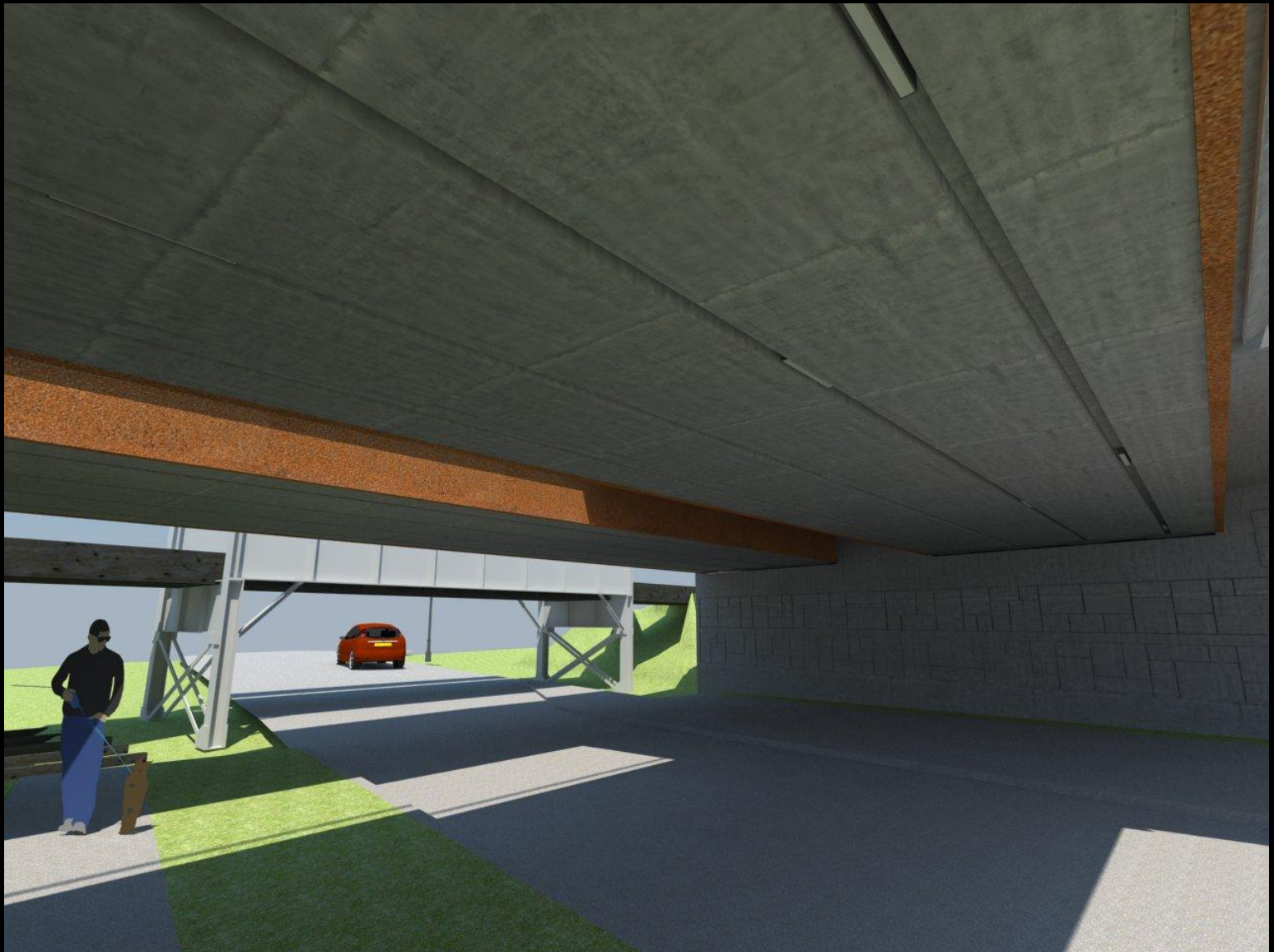

Kellogg Bridge

Jump Span Lighting

January 30, 2012

Winline Surface Linear 303W/305W Damp/Wet



Series: WSL - Winline Surface Linear
Model: 303W - Model 303W Wet
305W - Model 305W High Output Wet
Run Length: Total Run Length in Feet
Code: 303W Offered in 12" Increments
305W Offered in 6" Increments Starting at 12"
Ex: 50FT=60 Foot Run
or
Preconfigured Run Length Code
See www.winona-lighting.com
or
To Be Determined
TBD When Run Length Unknown

Beam Spread: 15° - 15°
30° - 30°
65° - 65°
110° - 110°
LED Code: 27K - ANSI-Binned 2700K
30K - ANSI-Binned 3000K
35K - ANSI-Binned 3500K
40K - ANSI-Binned 4000K
50K - Non-ANSI-Binned 5000K
Voltage: ND24V - Non-Dimming 24 Volt AC
DM24V - Dimming 24 Volt AC
Mount: F - Fixed
A - Adjustable
Finish: NAA - Natural Type III Anodized Aluminum
SGB - Semi-Gloss Black Paint
SGW - Semi-Gloss White Paint
CPF - Custom Paint Finish

Power Feed: SE - Surface End Feed
B2B - Back to Back
RA - Right Angle
RB* - Recessed Bottom Feed
*Recessed Bottom feed available on fixed mount only

Options: X - None
Special: STD - Standard
MOD - Modified



Winline Surface Linear 303W/305W are ETL listed for wet location and comply with UL Standard 2108.

PRODUCT SPECIFICATION

Series	Model	Run Length Code	Beam Spread	LED Code	Voltage	Mount	Finish	Power Feed	Options	Special
--------	-------	-----------------	-------------	----------	---------	-------	--------	------------	---------	---------

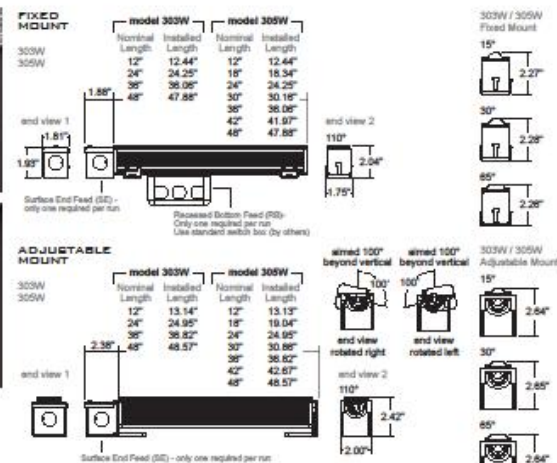

CONSTRUCTION

The Winline 303W and 305W are high performance linear LED luminaires suitable for the illumination and grazing of exterior walls, ceilings, and other planes. Robust in construction for ultimate durability, the housing is extruded aluminum, the adjustable mounts and end caps are die-cast, and the fixed mounts and all screws are stainless steel. The PTFE membrane on the end of the luminaire allows the fixture to breathe with changes in temperature, elevation, and pressure. This allows the luminaire to remain waterproof while allowing gases to discharge. The UV stable acrylic lens provides even beam control.

POWER AND DIMMING

Winline 303W power consumption is 8W/ft (maximum run length 40'). Winline 305W power consumption is 15W/ft (maximum run length 25'). The Winline 300 Series operates on 24VAC and can be dimmed with commonly available low voltage magnetic dimming equipment. A wide range of remote transformers are available in 120V and 277V primary (visit www.winona-lighting.com and click on Winline LED / LED linear for transformer details).

FIXED MOUNT

Two stainless steel mounting clips, combined with an integral wire tray, allow for ease of installation and organized wiring. The luminaire simply snaps into the fixed mounting clips where it is held securely in place and the wires are contained.

ADJUSTABLE MOUNT

The 300 Series adjustable mount allows for over 200 degrees of continuous rotation around the centerline of fixture. Adjustable mounts are die-cast and use stainless steel screws for durability. Once the luminaire is aimed accurately it can be securely locked into position.

OPERATING TEMPERATURE -22°F to 122°F (-30°C to 50°C)

COLOR AND LIGHT OUTPUT

The 300 Series utilizes Nichia 183 white LEDs in five standard colors. Model 303W features (6) LEDs/ft, while model 305W features (12) LEDs/ft.

LM79 Data - IES Test Report: 20530

Catalog Number: WSL-305W-48-15-30K-ND24V-F-NAA-SE-X-STD

Description: 48 Nichia 183 3000K LEDs / 48' Winline 305W Wet Luminaire

Color	Total Lumens	Lamp Watts	Lumens per Watt	CRI	Power Factor	Weight
ANSI-Binned 2700K	1554	57.2	26.8	85.7	.97	12" - 2.5 lbs
ANSI-Binned 3000K	1565	57.2	27.4	85.5	.96	18" - 3.4 lbs
ANSI-Binned 3500K	1831	57.2	32.0	84.5	.96	24" - 4.4 lbs
ANSI-Binned 4000K	1894	57.2	33.1	88.5	.96	30" - 5.3 lbs
ANSI-Binned 5000K	2180	57.2	37.8	70.1	.95	36" - 6.3 lbs
						42" - 7.2 lbs
						48" - 8.2 lbs

Complete photometric data and [submitals at www.winona-lighting.com](http://www.winona-lighting.com)
Winona Lighting reserves the right to make design changes without prior notice.

